

Green Pin® Standard Dee Shackles

with screw collar pin

- **Material** : bow and pin high tensile steel, Grade 6, quenched and tempered
- **Safety Factor** : MBL equals 6 x WLL
- **Standard** : EN 13889 and meets performance requirements of US Fed. Spec. RR-C-271 Type IVB Class 2, Grade A
- **Finish** : hot dipped galvanised
- **Temperature Range** : -20 °C up to +200 °C
- **Certificates** : as standard a works certificate is supplied, also upon request a certificate of basic raw material, manufacturer test certificate and/or EC declaration of conformity

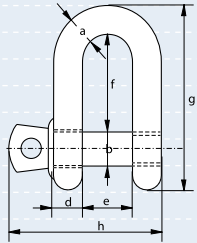

working load limit	diameter bow	diameter pin	diameter eye	width eye	width inside	length inside	length	length bolt	weight each
tons	a mm	b mm	c mm	d mm	e mm	f mm	g mm	h mm	kg
0.33	5	6	12.5	5	9.5	20	38	31	0.02
0.5	7	8	17	7	12	22	47	40	0.05
0.75	9	10	21	9	13.5	27	56	49	0.09
1	10	11	23	10	17	31	66	56	0.14
1.5	11	13	26	11	19	37	74	68	0.19
2	13.5	16	34	13.5	22	43	85	76	0.32
3.25	16	19	40	16	27	51	105	93	0.54
4.75	19	22	47	19	31	59	125	107	0.87
6.5	22	25	53	22	36	73	144	123	1.34
8.5	25	28	60	25	43	85	161	141	2.08
9.5	28	32	67	28	47	90	179	158	2.77
12	32	35	74	32	51	94	199	176	3.72
13.5	35	38	80	35	57	115	220	192	5.14
17	38	42	89	38	60	127	239	208	6.85
25	45	50	104	45	74	149	283	250	11.45
35	50	57	119	50	83	171	333	281	16.86
42.5	57	65	134	57	95	190	360	321	24.61
55	65	70	145	65	105	203	399	355	32.65

In inch

working load limit	diameter bow	diameter pin	diameter eye	width eye	width inside	length inside	length	length bolt	weight each
tons	a inch	b inch	c inch	d inch	e inch	f inch	g inch	h inch	lbs
0.33	3/16	1/4	1/2	3/16	3/8	25/32	1 17/32	1 1/4	0.04
0.5	1/4	5/16	11/16	9/32	1/2	7/8	1 7/8	1 9/16	0.11
0.75	5/16	3/8	13/16	11/32	17/32	1 3/32	2 3/16	1 15/16	0.20
1	3/8	7/16	29/32	3/8	11/16	1 1/4	2 19/32	2 3/16	0.30
1.5	7/16	1/2	1 1/32	7/16	3/4	1 1/2	2 29/32	2 11/16	0.42
2	1/2	5/8	1 11/32	17/32	7/8	1 23/32	3 11/32	3	0.70
3.25	5/8	3/4	1 19/32	5/8	1 3/32	2	4 1/8	3 11/16	1.19
4.75	3/4	7/8	1 7/8	3/4	1 1/4	2 5/16	4 29/32	4 3/16	1.92
6.5	7/8	1	2 3/32	7/8	1 7/16	2 7/8	5 11/16	4 13/16	2.95
8.5	1	1 1/8	2 11/32	1	1 23/32	3 11/32	6 5/16	5 9/16	4.59
9.5	1 1/8	1 1/4	2 5/8	1 1/8	1 7/8	3 9/16	7 1/32	6 3/16	6.10
12	1 1/4	1 3/8	2 29/32	1 9/32	2	3 23/32	7 13/16	6 29/32	8.20
13.5	1 3/8	1 1/2	3 5/32	1 3/8	2 1/4	4 17/32	8 11/16	7 9/16	11.33
17	1 1/2	1 5/8	3 1/2	1 17/32	2 11/32	5	9 3/8	8 3/16	15.10
25	1 3/4	2	4 1/8	1 25/32	2 29/32	5 7/8	11 5/32	9 13/16	25.23
35	2	2 1/4	4 11/16	1 31/32	3 3/32	6 3/4	13 1/8	11 3/32	37.17
42.5	2 1/4	2 9/16	5 9/32	2 1/4	3 3/4	7 1/2	14 5/32	12 5/8	54.26
55	2 1/2	2 3/4	5 3/4	2 9/16	4 1/8	8	15 23/32	14	71.98



DNV

TYPE APPROVED PRODUCT
CERTIFICATION NOTE 2.7-1
CERTIFICATE NO. S-4208

